

FK3040R

2M BLACK RECTANGULAR R200 TRUSS, F SERIES (F70FKR200B)

Section of aluminium square truss structure measuring 400 mm high and 300 mm wide, manufactured with main tube of 50 mm in diameter and 4 mm thick, and auxiliary tube of 25 mm in diameter and 3 mm thick. Especially suitable for assemblies with led screens. CBC50 conical connection system. It is available in 0.5 m, 1 m, 2 m, and 3 m lengths, and in silver or black. Includes 4 double cones, 4 pins, 4 threaded pins and 4 'R' safety clips. F SERIES compatible.

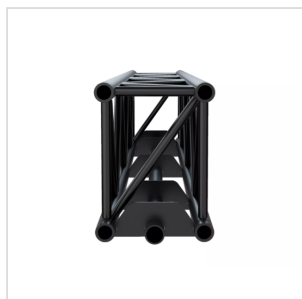
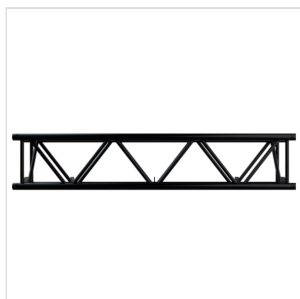

FK3040R

2M BLACK RECTANGULAR R200 TRUSS, F SERIES (F70FKR200B)



FK3040R

2M BLACK RECTANGULAR R200 TRUSS, F SERIES (F70FKR200B)

PRODUCT DETAILS

KEY FEATURES

Standard sizes: 0.5 / 1 / 2 / 3 m

Other sizes available upon request

Available in silver or black

Other colours available upon request

SPECIFICATIONS

Main Tube Section	50x4 mm/ 50x4 mm
Main Tube Alloy	EN AW 6082T6
Braces Section	25x3 mm/ 25x3 mm
Braces Alloy	EN AW 6082T6
Weight	12,05 kg/m
Surface Area Complete Truss	28,9 cm ²
Coupling System	CBC50
1.64 feet (0.5m) - Weight	7,26 kg
3.28 feet (1m) - Weight	12,61 kg
6.56 feet (2m) - Weight	22,16 kg
9.84 feet (3m) - Weight	31,96 kg
1.64 feet (0.5m) - Volume	0,06 m ³
3.28 feet (1m) - Volume	0,12 m ³

FK3040R

2M BLACK RECTANGULAR R200 TRUSS, F SERIES (F70FKR200B)

6.56 feet (2m) - Volume

0,24 m³

9.84 feet (3m) - Volume

0,36 m³

Colour

Black