

GC5T-SQW

## 5,25" PASSIVE CEILING/WALL-MOUNTED HIGH IMPEDANCE SPEAKER (SQUARE GRILLE, WHITE COLOR)

The GC5T is a 2-way passive loudspeaker with built-in 70/100V transformer, designed for large-scale distributed audio systems. Equipped with a 5.25" coaxial woofer and 0.75" titanium dome tweeter, it delivers a frequency response from 70 Hz to 20 kHz, 130° coverage, and SPL up to 109 dB.

It features a paintable frameless magnetic grille, available in round (GC5T-RN, with rotatable tweeter) or square (GC5T-SQ) versions, for seamless integration in environments such as malls, airports, stadiums, auditoriums, or theme parks.

Like all GC series models, it operates based on the infinite baffle principle, requiring no back box. It is optimized for drywall, wood, or tile ceilings and walls. With just 75 mm depth and 1.08 kg weight, it ensures compact size and easy installation without compromising performance.

The 70/100V constant voltage configuration allows power selection up to 16W at 100V, enabling the connection of multiple speakers in parallel on a single line. The GC5T is fully compatible with all standard 70/100V amplifiers.

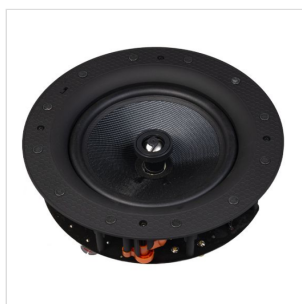

GC5T-SQW

# 5,25" PASSIVE CEILING/WALL-MOUNTED HIGH IMPEDANCE SPEAKER (SQUARE GRILLE, WHITE COLOR)

---

## HIGHLIGHTS

---

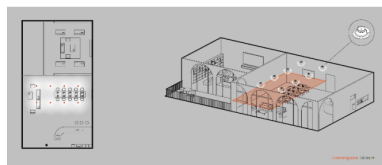

### LARGE-SCALE INSTALLATIONS WITHOUT COMPROMISE

Thanks to the integrated transformer for **100V/70V** lines, this high-impedance loudspeaker **allows several speakers to be connected in parallel over long distances without significant loss of power or audio quality**, making it ideal for distributed systems in hotels, shopping centres, schools or public facilities.

### FRAMELESS DESIGN FOR SEAMLESS ARCHITECTURAL INTEGRATION

The grille with no visible frame allows the GC5T to virtually disappear after installation, delivering a clean, minimalist aesthetic—ideal for refined interiors or design-sensitive environments.



# GC5T-SQW

## 5,25" PASSIVE CEILING/WALL-MOUNTED HIGH IMPEDANCE SPEAKER (SQUARE GRILLE, WHITE COLOR)

### PRODUCT DETAILS

#### KEY FEATURES

Wide and uniform diffusion thanks to the 130° conical coverage: perfect for distributed sound systems in environments where wide and uniform coverage is required, such as retail, hospitality, public places or conference rooms, but also in residential and/or private environments.

Balanced audio quality: The coaxial configuration ensures a uniform frequency response (60Hz–20kHz) and better coherence between highs and mids, with a maximum SPL of 112dB suitable for small to medium environments.

Orientable titanium tweeter for precision and definition: titanium, thanks to its lightness and rigidity, allows the tweeter to offer a rapid and precise response, with bright and defined high frequencies. Ideal in contexts where clarity and intelligibility are essential, such as conferences, acoustic music concerts and public spaces.

Compact and lightweight design: very easy to install in small spaces or on ceilings/walls. Ideal for discreet architectural integrations.

Installazione semplificata senza alcuna scatola posteriore: ideale per pareti o soffitti in cartongesso, legno o piastrelle, utilizzando il principio "infinite baffle", l'altoparlante è isolato posteriormente dalla parete o dal soffitto di grandi dimensioni in cui è installato, evitando che le onde sonore anteriori e posteriori si annullino a vicenda (sfasamento tra anteriore e posteriore).

#### SPECIFICATIONS

Type	Passive Fullrange Loudspeaker
Transducers	5,25" coax ferrite magnet woofer with 0.75" titanium dome tweeter
Frequency Response	70Hz-20kHz (-10 db)
Max.SPL	109dB
Rated Power	2/4/8/16W@100V - 1.25/2/4/8W@70V
Coverage	V. 130°   H. 130°
Dimensions (W x H x D)	227x210x87 mm (8.9x8.3x3.4 in)
Weight	1,52 kg (3.3 lb)

GC5T-SQW

## 5,25" PASSIVE CEILING/WALL-MOUNTED HIGH IMPEDANCE SPEAKER (SQUARE GRILLE, WHITE COLOR)

---

Material	ABS
Colors	Bianco
Connectors	Spring terminals
Nominal Impedance	70/100 V